

Manufacturing Systems and Equipment for the Automotive and Industrial Markets



WASHING



LIFTING



VACUUMING



HANDLING



CRUSHING

OWNER'S

MANUAL

Models:

O500

O505



INSTRUCTIONS

This manual contains important information concerning the installation and operation of the gun washers listed at the right. **Read manual thoroughly and keep for future reference.**

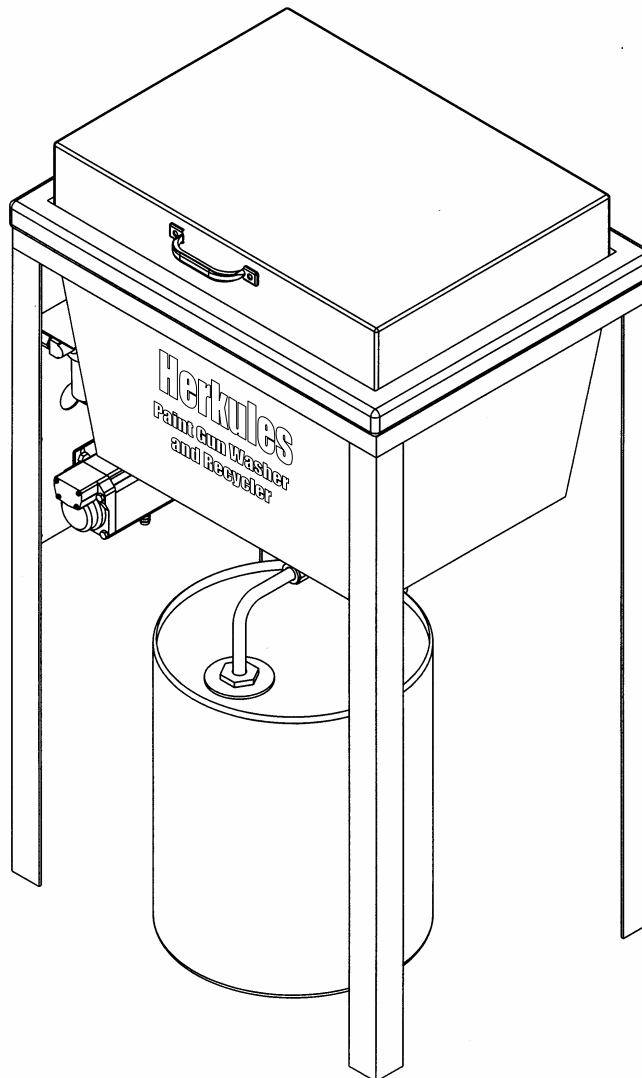

01980973(200)

Table of Contents

Warnings	3-4
Model Information	5
Installation	5
Operation	6-7
Preventive Maintenance	8
Troubleshooting	9
Notes	10

Drawings with part lists

318 Diaphragm Pump Port Connections	11
O500	12-13
O505	14-15

Warning Symbol



This symbol alerts you to the possibility of serious injury or death if you do not follow the instructions.

Caution Symbol



This symbol alerts you to the possibility of damage to or destruction of equipment if you do not follow the instructions.

Serial Number _____

Purchase Date _____

Model Number _____

Distributor _____



WARNING



INSTRUCTIONS

EQUIPMENT MISUSE HAZARD

Equipment misuse can cause the equipment to rupture, malfunction, or start unexpectedly and result in serious injury.

- This equipment is for professional use only.
- Read all instruction manuals, tags, and labels before operating the equipment.
- Use the equipment only for its intended use.
- Do not alter or modify this equipment.
- Do not exceed the maximum working pressure of the lowest rated system component.
- Do not operate the gun washer at a pressure above the maximum working pressure rating of the gun(s) being cleaned.
- Route the hoses away from traffic areas, sharp edges, moving parts, and hot surfaces.
- Do not use the hoses to pull the equipment.
- Do not move pressurized equipment.
- Use fluids or solvents that are compatible with the equipment wetted parts. Read the fluid and solvent manufactures warnings.
- Comply with all applicable local, state and national fire, electrical and other safety regulation.



PRESSURIZED EQUIPMENT HAZARD

Spray from hose leaks, ruptured components, or from operating the gun washer with an open lid can splash fluid in the eyes or on the skin and cause serious injury.

- A safety device has been installed to shut off the pump when the gun washer lid is opened. Do not tamper with or alter this device.
- Open the gun washer lid slowly.
- Do not prop the gun washer lid open with an object or by any other means.
- Do not stop or deflect fluid leaks with your hand, body, glove, or rag.
- Tighten all fluid connections before operating the equipment.
- Replace worn, damaged, or loose parts immediately.

WARNING



FIRE AND EXPLOSION HAZARD

Improper grounding, poor air ventilation, open flames, or sparks can cause a hazardous condition and result in fire or explosion and serious injury.

- Ground the equipment. See Installation for grounding procedure.
- Provide fresh air ventilation to avoid the build up of flammable fumes from the solvent.
- Extinguish all open flames or pilot lights in gun washer area.
- Electrically disconnect all equipment in the gun washer area.
- Keep the gun washer area free of debris, including solvent, rags, and gasoline.
- Do not turn on any light switch in the gun washer area while operating or if fumes are present.
- Do not smoke in the gun washer area.
- Do not operate a gasoline engine in the gun washer area.
- Follow the gun manufactures solvent and other cleaning recommendations.
- Use solvent with the highest possible flash point.
- If there is any static sparking while using the equipment, **stop operation immediately**. Identify and correct the problem.
- Drain the solvent into a proper storage container when gun washer(s) is not in use.

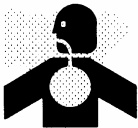

TOXIC FLUID HAZARD

Hazardous fluids or toxic fumes can cause serious injury or death if splashed in eyes or on the skin, swallowed, or inhaled.

- Know the specific hazards of the fluid you are using. Read the fluid manufactures warnings.
- Store hazardous fluid in an approved container. Dispose of hazardous fluid according to all local, state and national guidelines.
- Wear the appropriate protective clothing, gloves, eyewear and respirator.
- Pipe and dispose of the exhaust air safely. If diaphragm fails, the fluid may be exhausted along with the air.

Model Information

Model	Description	Weight (kg.)	Dim. A (mm.)	Dim. B (mm.)	Dim. C (mm.)
O500	One gun, one cup paint gun washer / recycler with diaphragm pump, filter-regulator, and timer.	45 (20)	20.5 (521)	15.625 (397)	35 (889)
O505	O500 for use with water based cleaning solutions or standard lacquer thinner solvents.	48 (22)	20.5 (521)	15.625 (397)	35 (889)

Model shown: O500

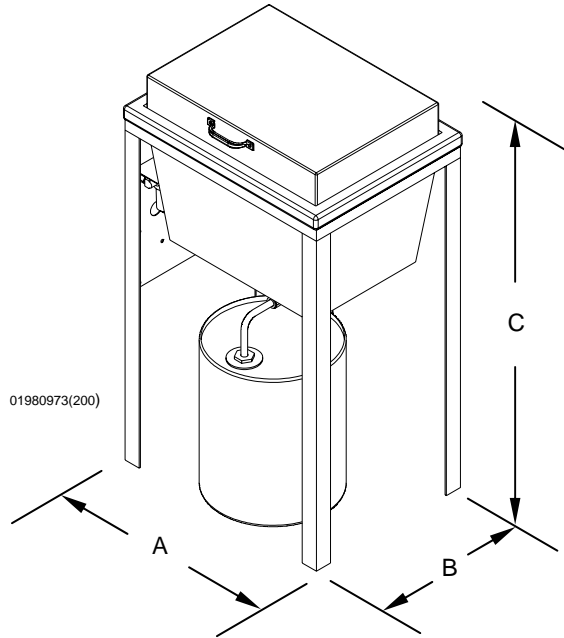

Installation

Installing the Gun Washer

1. Place gun washer on a level surface in a properly ventilated paint mixing room.

Grounding the Gun Washer

1. Connect the ground wire on the gun washer to a true earth ground.
2. Ground all equipment used or located in the gun washer area.

Connecting the Air Line

1. Install a 1/4 in. npt male coupler into the air inlet at the left front of the housing. Hand tighten the 1/4 in. npt coupler into the inlet. Then, wrench tighten 1/4 turn.

2. Connect a permanent shop air line of 65-120 psi. Filter/regulator is preset. Do not adjust

Connecting the Solvent to the Washer

1. Insert the white, plastic siphon plug into a fresh 5 gallon solvent can. The can must contain at least 4 gallons of solvent to pump properly. Use a high quality, slow evaporating solvent, such as DuPont's 3661S or equivalent.
2. Place the siphon tube into the 5-gallon can through the white plastic plug. Attach the flare nut end of the siphon tube to the flare fitting on the underside of the mini gun washer. Tighten the flare nut by hand and snug with wrench. **IMPORTANT:** Do not over tighten.

Operation

Preparing the Equipment to be washed

1. Remove paint cup or paint line and the air line from the paint gun.
2. Drain excess paint from cup and gun.
3. Remove all gauges and regulators.

CAUTION

All pressure gauges must be removed before placing equipment in gun washer to avoid damaging the gauges.

4. Lock the gun trigger in the open position by placing the trigger lock around the gun handle and trigger (see Fig. 1).

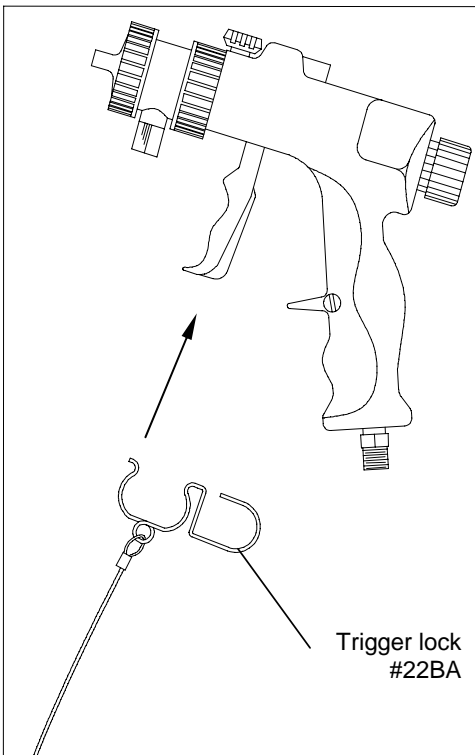

Figure 1

01970826

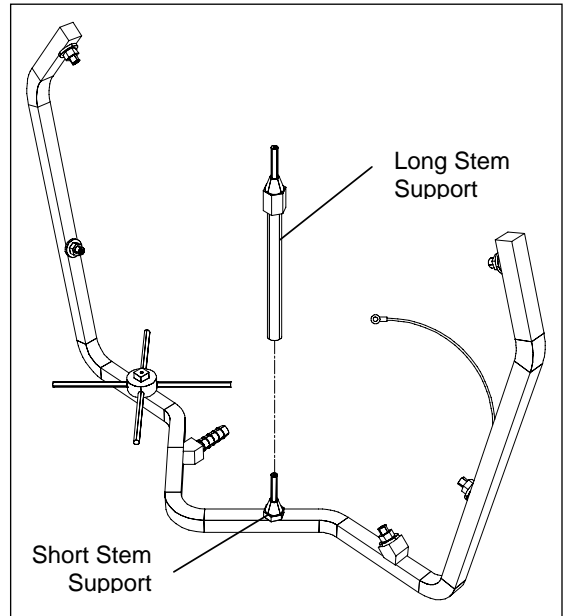

Figure 2

01960415(254)

Placing Equipment in the Gun Washer

1. To clean guns not mentioned here, use the long or short stem supports as needed (see Fig. 2). For questions or adapter kits contact your paint gun washer distributor.
2. The shorter support is designed for siphon feed and pressure feed guns of up to 2 quart capacity which are fitted with siphon tube intakes.
3. The long support is designed to hold gravity feed guns or pressure feed guns that have been removed from the air and paint lines. All pressure gauges must be removed before washing the paint gun.

Placing Paint Guns in Washer

Siphon Feed

Place siphon tube onto short stem support nozzle.

Gravity Feed

Place long stem support over one of the short stem supports. Place paint inlet of gun on long stem support.

*For Gravity Feed, High Volume Low Pressure Guns an adapter kit (part number 23K) is available from your distributor for best cleaning.

Placing Paint Guns in Washer (cont.)

HVLP - Mattson

Use gun manufacturer's fixtures. 1/4" plastic trigger lock holds sliding rod open. Tubing with quick disconnect to gun and a permanent connect to gun washer manifold completes the special fixtures. Place paint pickup tube onto shorter stem support nozzle.

Pressure Feed

Cleaning Options for Pressure Pot Systems

1. *Paint gun only:* Place onto long stem nozzle (use moveable 6 1/4" stem over the short stem). Remove gauges and regulators. Apply wire trigger lock to gun.
2. *Pot lid only:* Place paint pickup tube over short stem nozzle. Remove gauges.
3. *Pot lid and attached:* Place paint pickup tube over paint line short stem nozzle and coil paint line on bottom.
4. *Pot lid with paint line attached and gun attached:* Apply wire trigger lock to gun. Follow step 3 and lay gun on top of hose.
5. *Pot only:* Place over one of two nozzles.
6. *All equipment at the same time:* Follow steps 1, 3 and 5.

* For long lengths of paint hose or to clean the paint hose passage outside of the gun washer tub with a pressure flow hookup of solvent, please contact a Herkules Distributor for Herkules pressure pot system Paint gun washers, the GW/R-3 and GW/R-3-SS models.

Operating the Gun Washer

1. Make sure all wire trigger locks and other accessories are inside the gun washer tank.
2. If washing only one set of equipment, place empty cans over the unused nozzles and/or stem supports to prevent solvent spray from hitting the underside of the gun washer lid.
3. Close the gun washer lid.
4. Turn the timer knob clockwise 90 degrees to start the gun washer. The gun washer will run for 90 seconds. Turning the timer knob less than 90 degrees will reduce the timing cycle. Paint equipment will clean in 60 to 90 seconds.
5. If the lid is opened prior to the end of the timing cycle, the safety air cutoff switch will stop the gun washer. The gun washer will start again when the lid is closed if time remains on the timer.

Note: Open the lid slowly to minimize solvent vapor escape.
6. Remove the equipment from the gun washer and wipe off any remaining solvent. The gun hanger on the front of the stand can be used to dry the guns.

Preventive Maintenance

1. Drain excess paint from cup or pot into separate container before loading into washer.
2. Drain paint sludge from 5 gallon solvent can weekly. Do after weekend settling.

Pour liquid into second container. Drain sludge into disposal container. Refill can from second container and add solvent for minimum 4 gallon level or 3" from the top.

Clean siphon tube with cloth and brush to remove paint residue

3. Clean filter weekly. Unscrew gray filter cup in solvent tubing line. Place container or cloths underneath to catch any liquid spill. Remove stainless screen. Rinse both pieces and install.
4. Clean inside of tub.
5. Change solvent completely when objects being cleaned become tacky to the touch.
6. Drain water from filter/regulator at least weekly. Press the water drain pin up (See Fig 3).

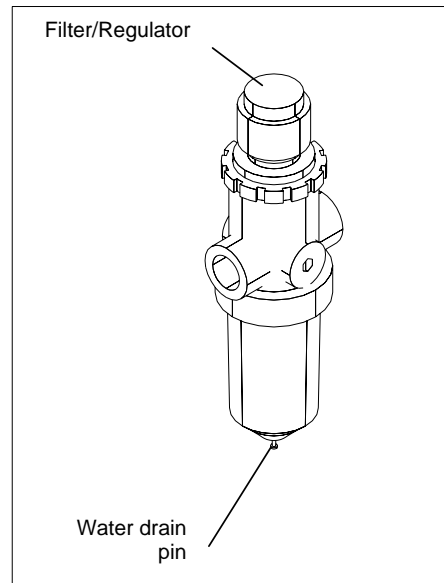

Figure 3

01970836

CAUTION

Do not change the setting of the filter/regulator. This could damage the filter/regulator or pump.

Troubleshooting

Problem	Possible Solution
Gun washer will not turn on.	<ol style="list-style-type: none"> 1. Make sure the air line is properly connected with 90-120 psi. 2. Make sure lid is fully closed. Make sure the limit valve (#M1C) on the side of the tank is in closed position. 3. Check all air connections to ensure that there are no leaks. 4. Make sure timer cam is engaging the limit valve (#M1C) on the shield assembly. 5. Make sure timer is on and functioning correctly.
Gun washer turns on but pumps slowly or not at all.	<ol style="list-style-type: none"> 1. Make sure intake filter is not clogged (Clean or replace). See number 3 of PREVENTIVE MAINTENANCE 2. Make sure the air line is properly connected with 90-120 psi. 3. Check all air connections to ensure that there are no leaks. 4. Drain filter/regulator of water. See number 6 of PREVENTIVE MAINTENANCE. 5. Make sure the solvent can is at least 4/5 full of clean solvent. 6. Make sure lid is fully closed. Make sure the limit valve (#M1C) on the side of the tank is fully actuated. 7. Make sure manifold nozzles and stem supports are not clogged. 8. Make sure ball moves freely in ball cage. Expand ball cage slightly if ball is lodged in ball cage. 9. Make sure teflon o-ring is present and in good condition with in the strainer assembly. 10. Make sure siphon tube connection is wrench tight. 11. Make sure strainer bowl is tight
Gun washer will not shut off.	<ol style="list-style-type: none"> 1. Make sure timer cam (#M230-001A) is moving. If its not, slightly loosen the nuts holding the limit valve (#M1C) on the shield. Reposition valve and tighten nuts.

Notes

318 Diaphragm Pump Port Connections

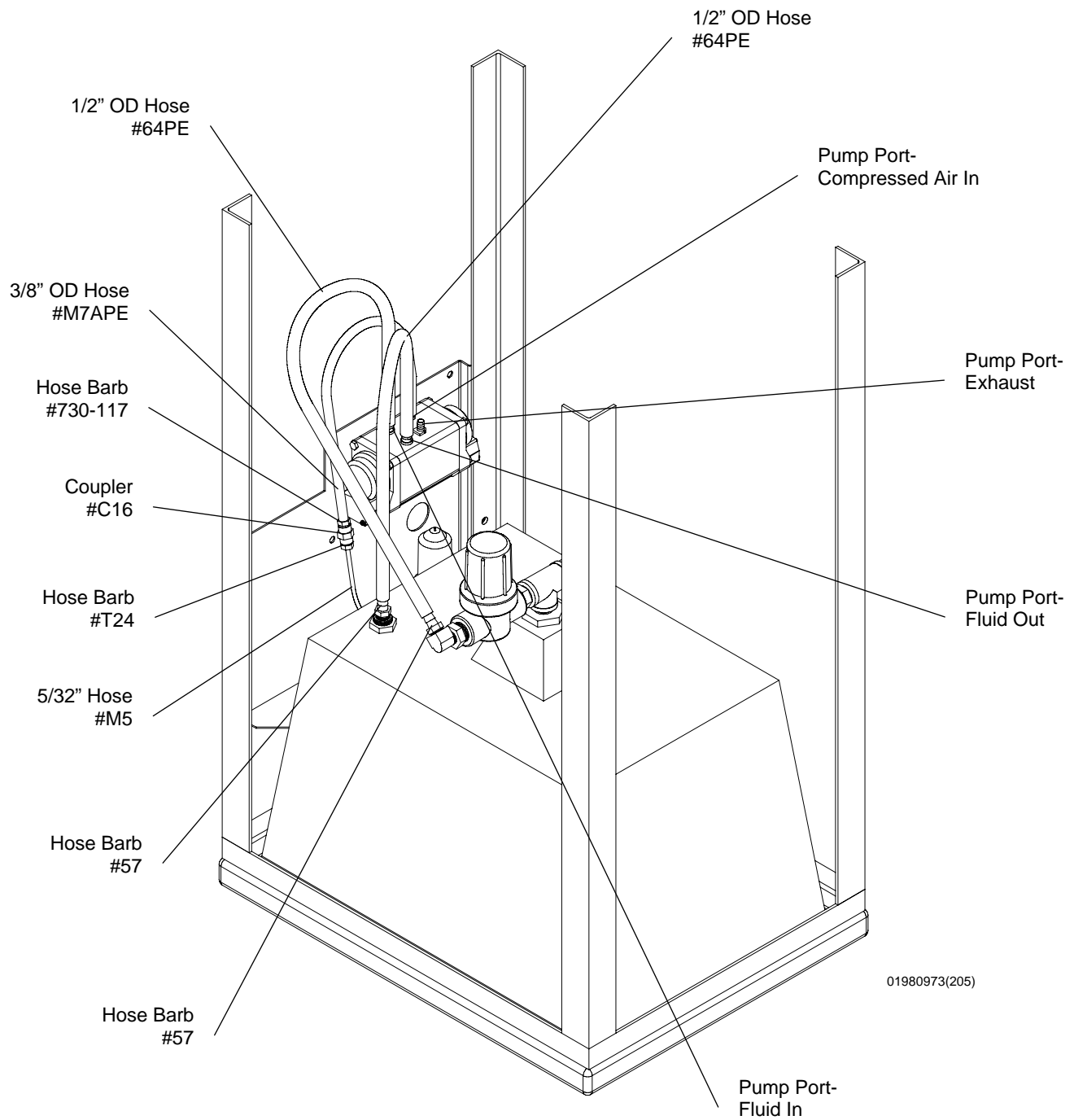

Parts Layout of O500

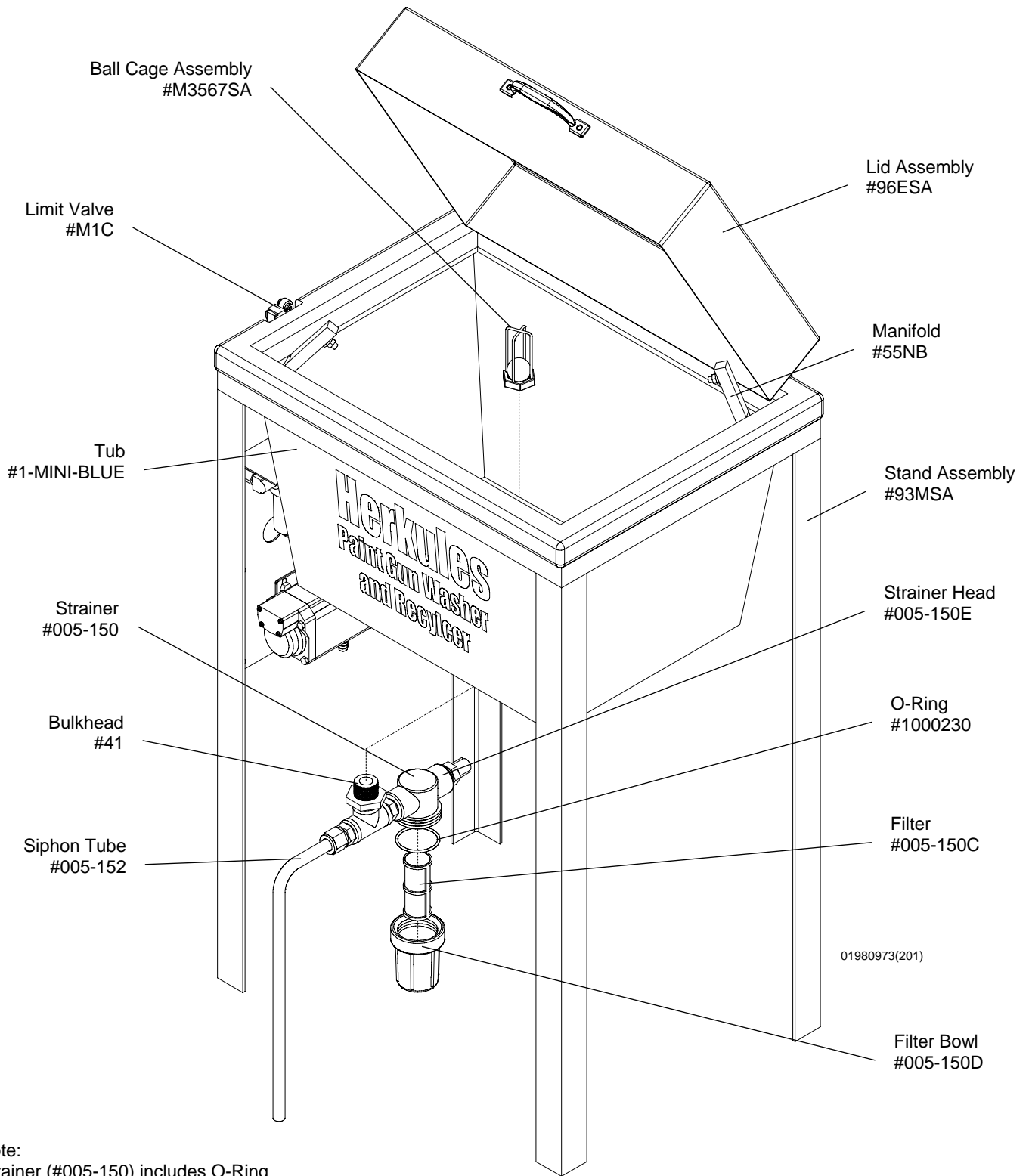

Note:
Strainer (#005-150) includes O-Ring (#1000230), Filter (#005-150C), Strainer bowl (#005-150D), and Strainer head (#005-150E) .

Manifold Assembly
#55NB

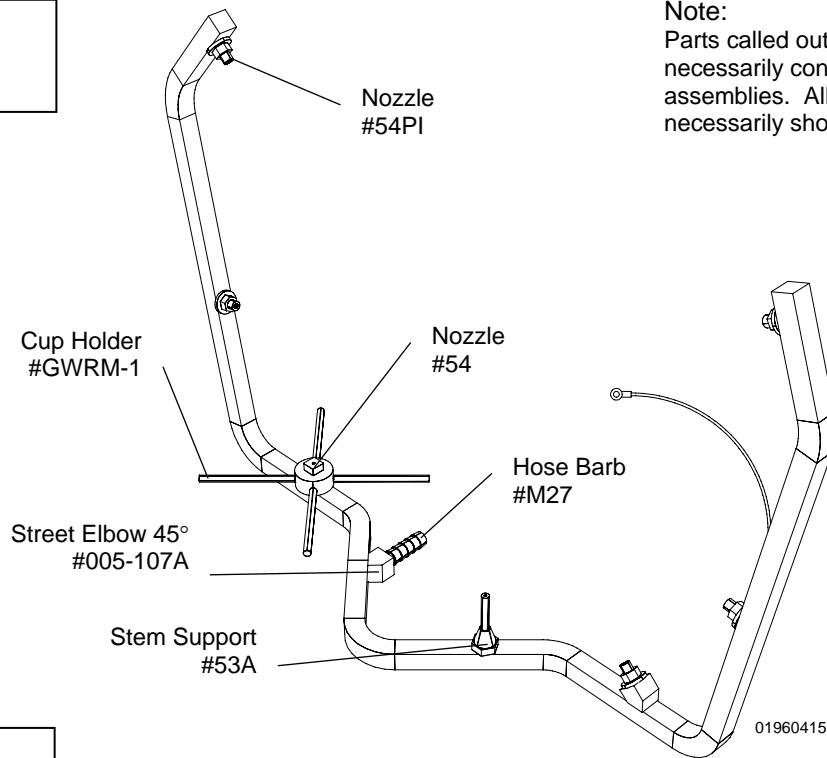

Note:
Parts called out are not necessarily contained in the assemblies. All parts are not necessarily shown or called out.

Shield Assembly
#318-001SA

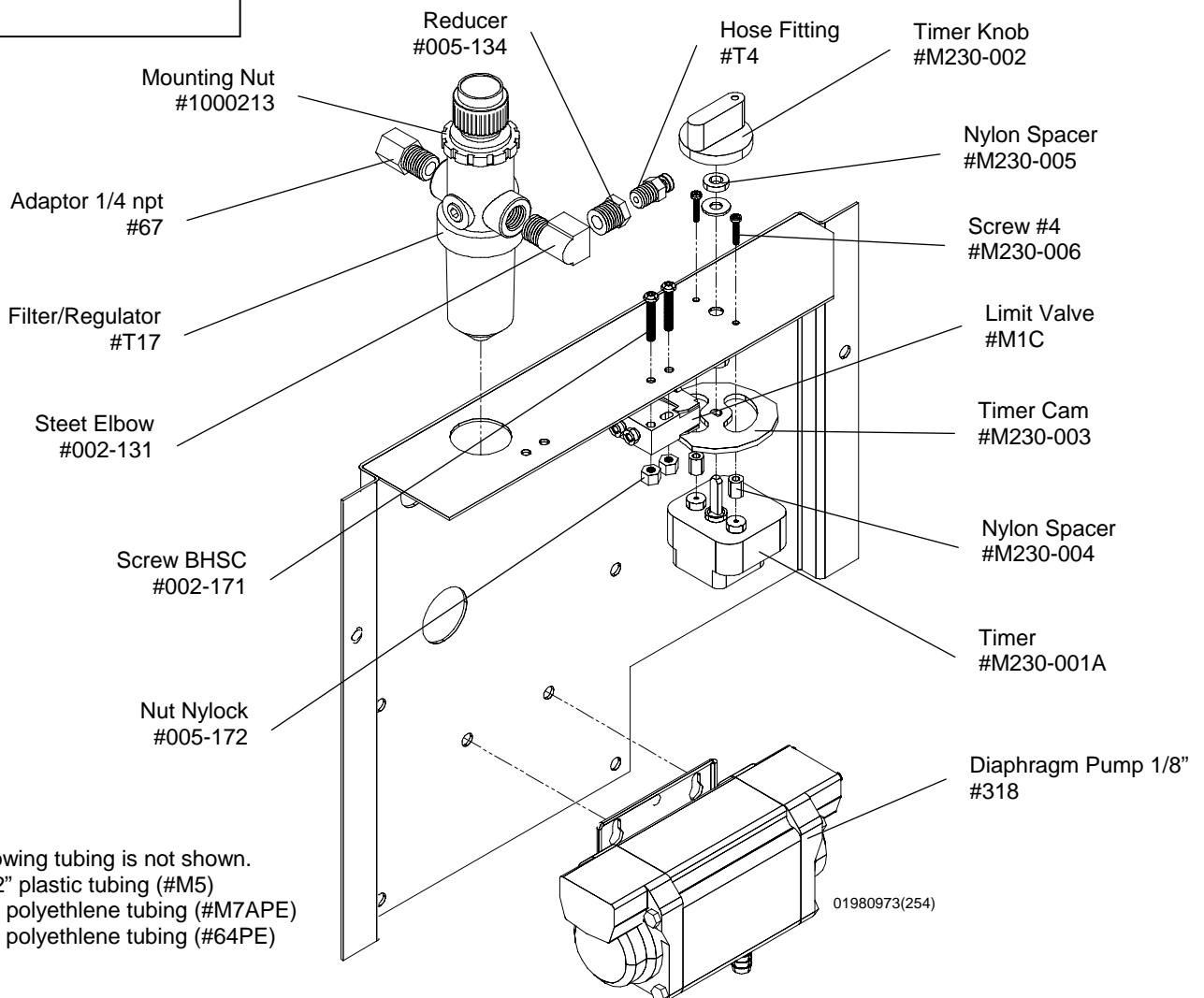

Note:
The following tubing is not shown.
5/32" plastic tubing (#M5)
3/8" polyethylene tubing (#M7APE)
1/2" polyethylene tubing (#64PE)

Parts Layout of O505

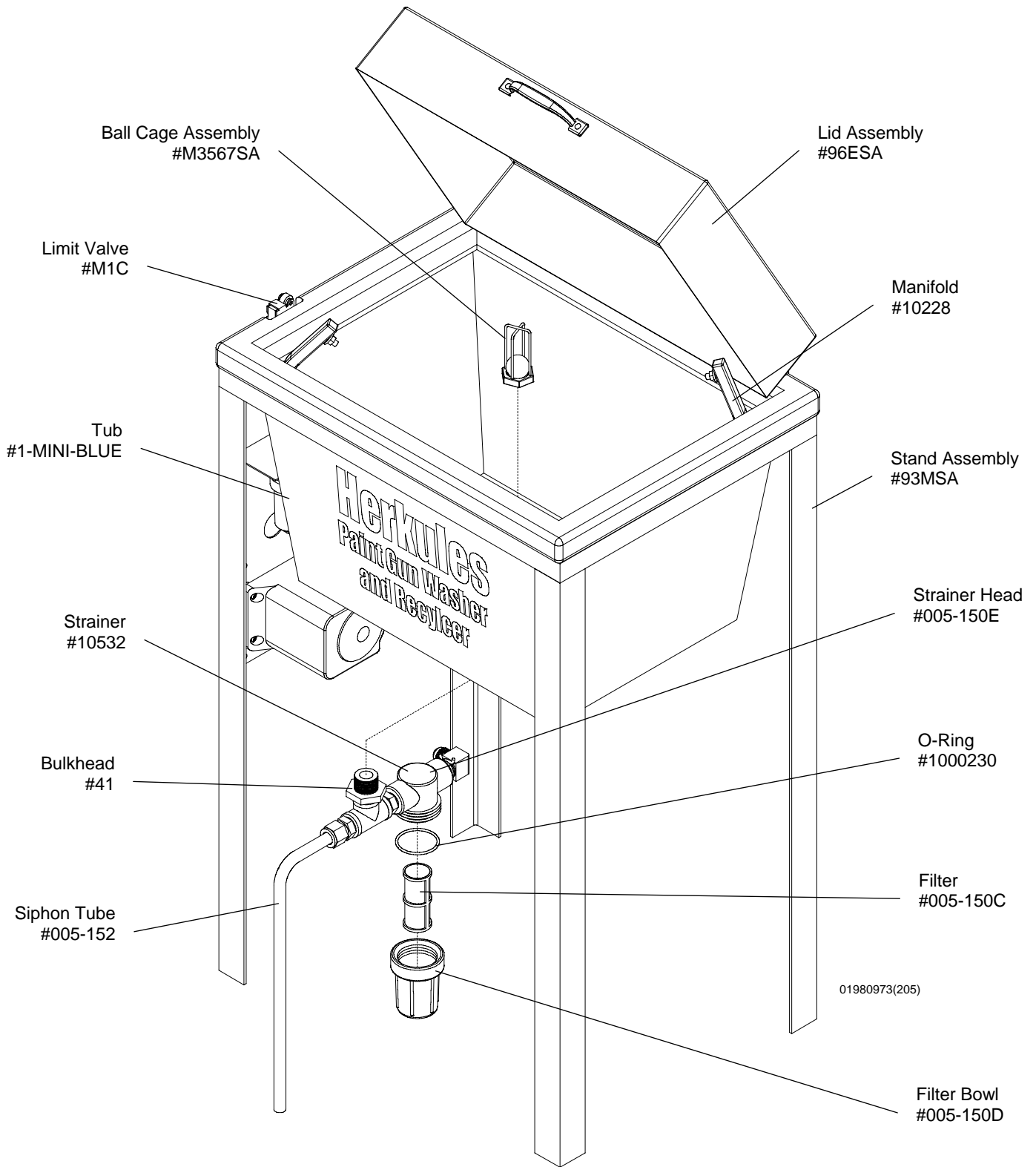

Note:
 Strainer (#005-150) includes O-Ring (#1000230), Filter (#005-150C), Strainer bowl (#005-150D), and Strainer head (#005-150E) .

Manifold Assembly S.S.
#10228

Note:
Parts called out are not necessarily contained in the assemblies. All parts are not necessarily shown or called out.

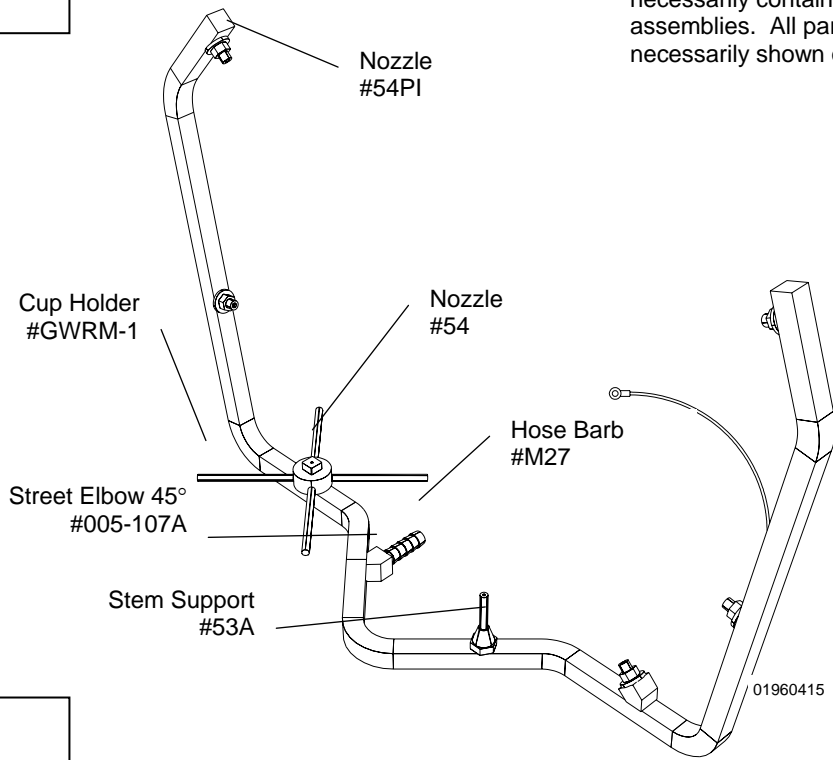

Shield Assembly
#10248

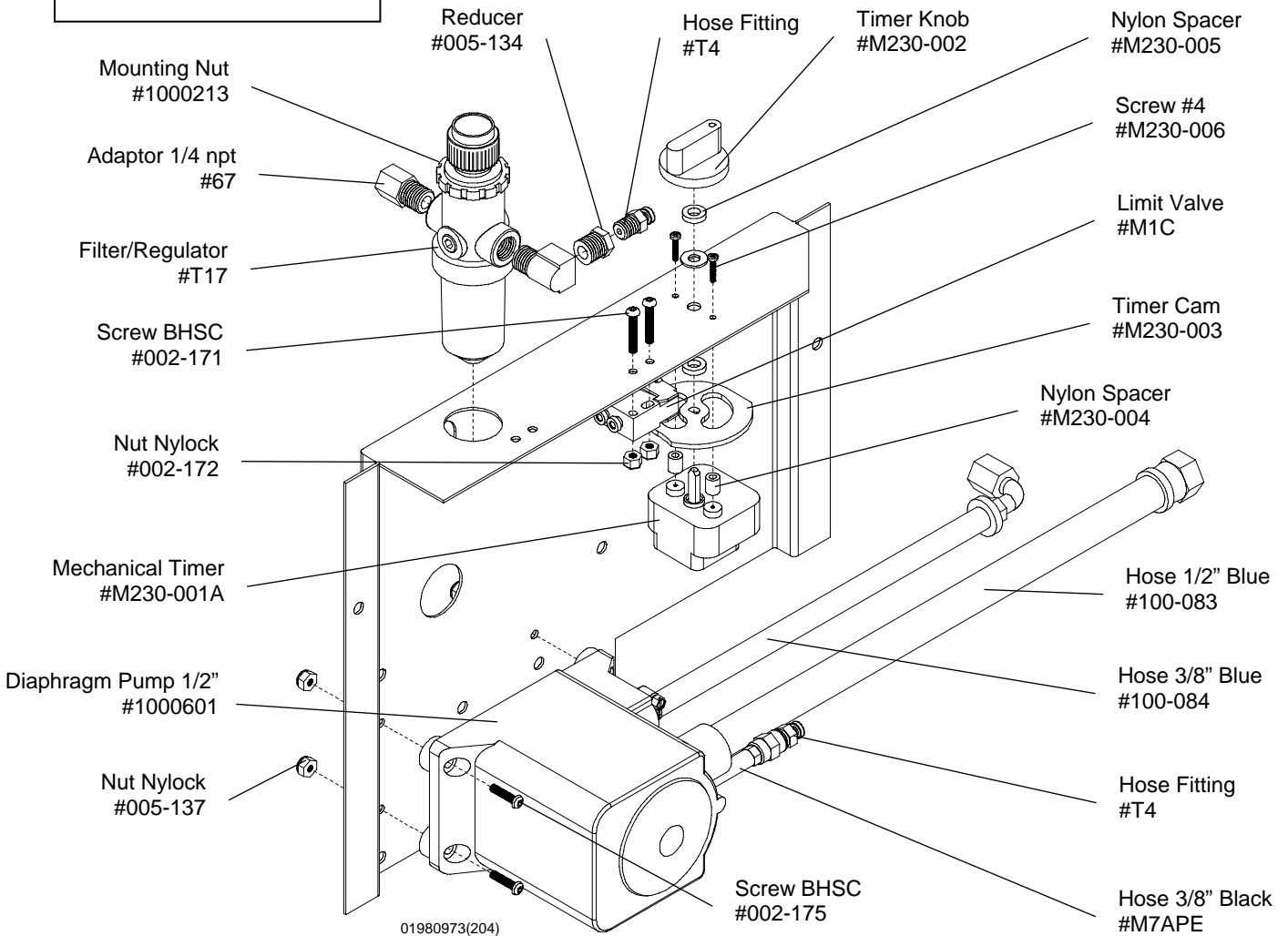

Note:
The following tubing is not shown.
5/32" plastic tubing (#M5)